

# **APPENDIX C**

## **PRELIMINARY CIVIL SITE PLANS**

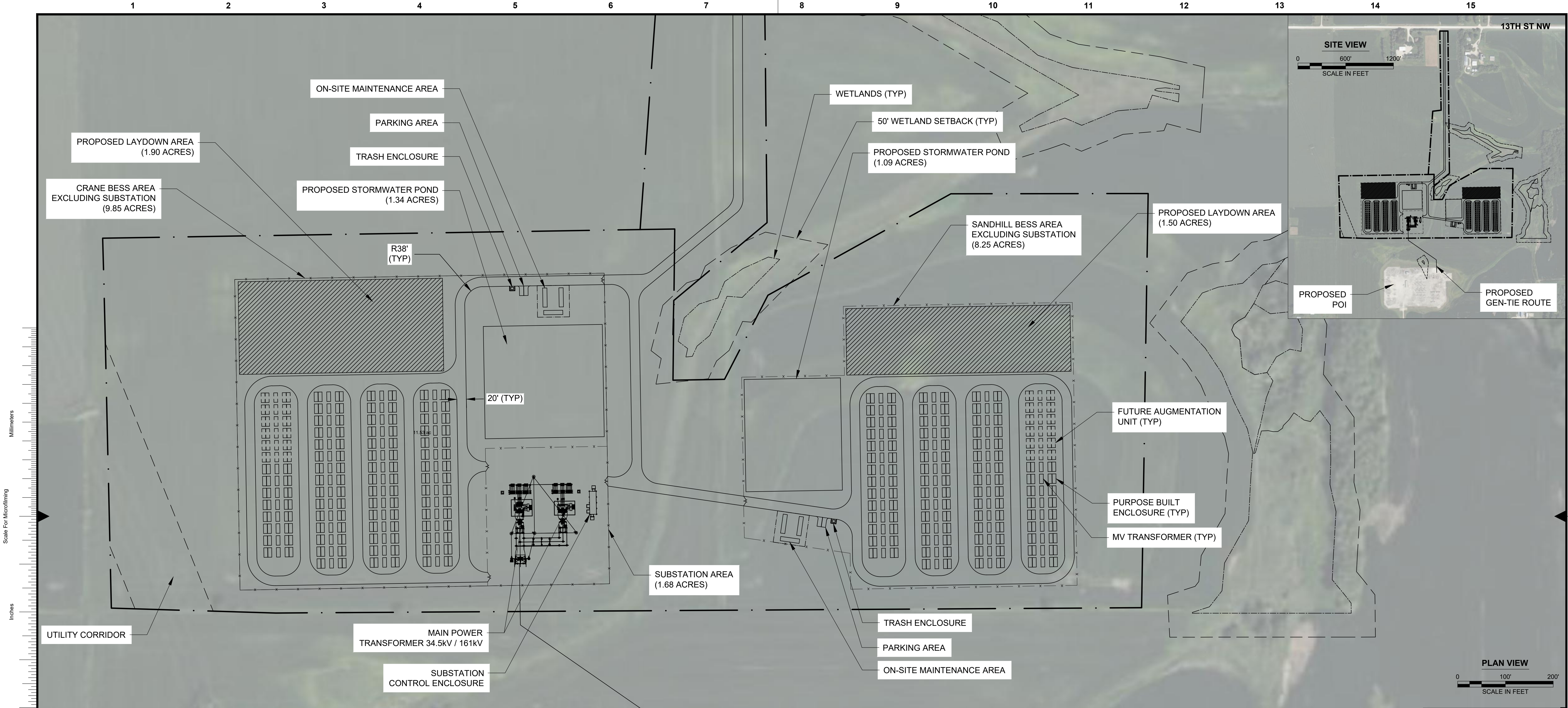

CRANE DESCRIPTION	
NAMEPLATE	200 MW / 800 MWh
CRANE MATERIAL LIST	
NUMBER OF PURPOSE BUILT ENCLOSURES (BOL)	212
NUMBER OF PURPOSE BUILT ENCLOSURES (EOL)	236
NUMBER OF MEDIUM VOLTAGE TRANSFORMERS (BOL)	53
NUMBER OF MEDIUM VOLTAGE TRANSFORMERS (EOL)	59

SANDHILL BESS DESCRIPTION	
NAMEPLATE	200 MW / 800 MWh
SANDHILL MATERIAL LIST	
NUMBER OF PURPOSE BUILT ENCLOSURES (BOL)	212
NUMBER OF PURPOSE BUILT ENCLOSURES (EOL)	236
NUMBER OF MEDIUM VOLTAGE TRANSFORMERS (BOL)	53
NUMBER OF MEDIUM VOLTAGE TRANSFORMERS (EOL)	59

- LEGEND:**
- LIMITS OF DISTURBANCE
  - x - x - FENCE
  - - - SETBACK
  - ⋈ GATE

- ABBREVIATION LIST:**
- BESS - BATTERY ENERGY STORAGE SYSTEM
  - BOL - BEGINNING OF LIFE
  - EOL - END OF LIFE
  - PCS - POWER CONVERSION SYSTEM
  - POI - POINT OF INTERCONNECTION
  - TYP - TYPICAL

- NOTES:**
1. FINAL LAYOUT SUBJECT TO CHANGE BASED ON FINAL ENVIRONMENTAL, CIVIL, GEOTECHNICAL, AND AUTHORITY HAVING JURISDICTION REQUIREMENTS.
  2. EQUIPMENT QUANTITIES, CONFIGURATION, AND FOOTPRINT SUBJECT TO CHANGE BASED ON FINAL BESS TECHNOLOGY SELECTION AND ADDITIONAL PROJECT DUE DILIGENCE.
  3. CIVIL GRADING AND STORMWATER NOT CONSIDERED IN LAYOUT DEVELOPMENT.
  4. DESIGN MAINTAINS FACILITY NAMEPLATE RATING THROUGH YEAR 20. AUGMENTATION EVENTS OCCUR AT YEARS 6, 10, 13, AND 17.
  5. LANDSCAPING NOT INCLUDED IN LAYOUT DEVELOPMENT.
  6. WATER SUPPLY, SUCH AS TANKS, FIRE WATER LOOP, AND/OR HYDRANTS NOT INCLUDED OR CONSIDERED IN LAYOUT DEVELOPMENT.
  7. WETLANDS, FLOODPLAINS, AND OTHER ENVIRONMENTAL CONSIDERATIONS SUBJECT TO CHANGE.



**PRELIMINARY - NOT FOR CONSTRUCTION**

C	10/21/2024	MRA	EDV	ISSUED FOR REVIEW	
B	03/11/2024	MRA	EDV	ISSUED FOR REVIEW	
A	01/18/2024	MRA	JLT	ISSUED FOR REVIEW	
no.	date	by	ckd	description	



no.	date	by	ckd	description	



9400 WARD PARKWAY  
KANSAS CITY, MO 64114  
816-333-9400  
Burns & McDonnell Engineering Co., Inc.

designed  
M. ANSTINE

detailed  
M. ANSTINE



OLMSTED COUNTY, MINNESOTA

TENASKA CRANE & SANDHILL BATTERY ENERGY STORAGE SYSTEMS SITE PLAN	
project	contract
drawing	rev.
<b>LAYOUT — C</b>	
sheet 1 of 1 sheets	
file TenaskaCraneSandhillLayout.dwg	