

ESRI, CGIAR, USGS, University of Minnesota Duluth, Esri, HERE, Garmin, Bing Maps, GeoTechnology, Inc., METI/NASA, USGS, EPA, NPS, USDA

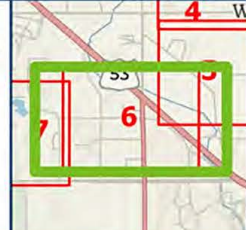

- |                                      |  |
|--------------------------------------|--|
| Route Width                          | Designated Trout Stream                        |
| Relocated Distribution               | Protected Tributary to Designated Trout Stream |
| 115 kV Transmission (Single Circuit) | Public Water Natural Watercourse               |
| 115 kV Transmission (Double Circuit) | Public Water Altered Watercourse               |
| 230 kV Transmission (Single Circuit) | Impaired Stream                                |
| Removed Transmission (Realigned)     | Public Waterbody                               |
| Thermal Upgrades                     |  |
| New Underground Fiber                |  |

- NWI (non-delineated)
- |                                   |
|-----------------------------------|
| Freshwater Emergent Wetland       |
| Freshwater Forested/Shrub Wetland |
| Freshwater Pond                   |
| Lake                              |
| Riverine                          |
| Freshwater Forested Wetland       |

- Hermantown Trails
- |                       |
|-----------------------|
| Superior Hiking Trail |
| Snowmobile Trail      |
- Duluth Trails
- |                   |
|-------------------|
| Hiking and Biking |
| Hiking            |
| Multipurpose      |
| Nordic            |

- |                          |
|--------------------------|
| Aquatic Management Area  |
| Other Forest Land        |
| Wildlife Management Area |
| FEMA Floodplain          |

- |            |
|------------|
| Ski Area   |
| Cemeteries |

Route Detail  
Plate 6

